

ŘEZ A-A'

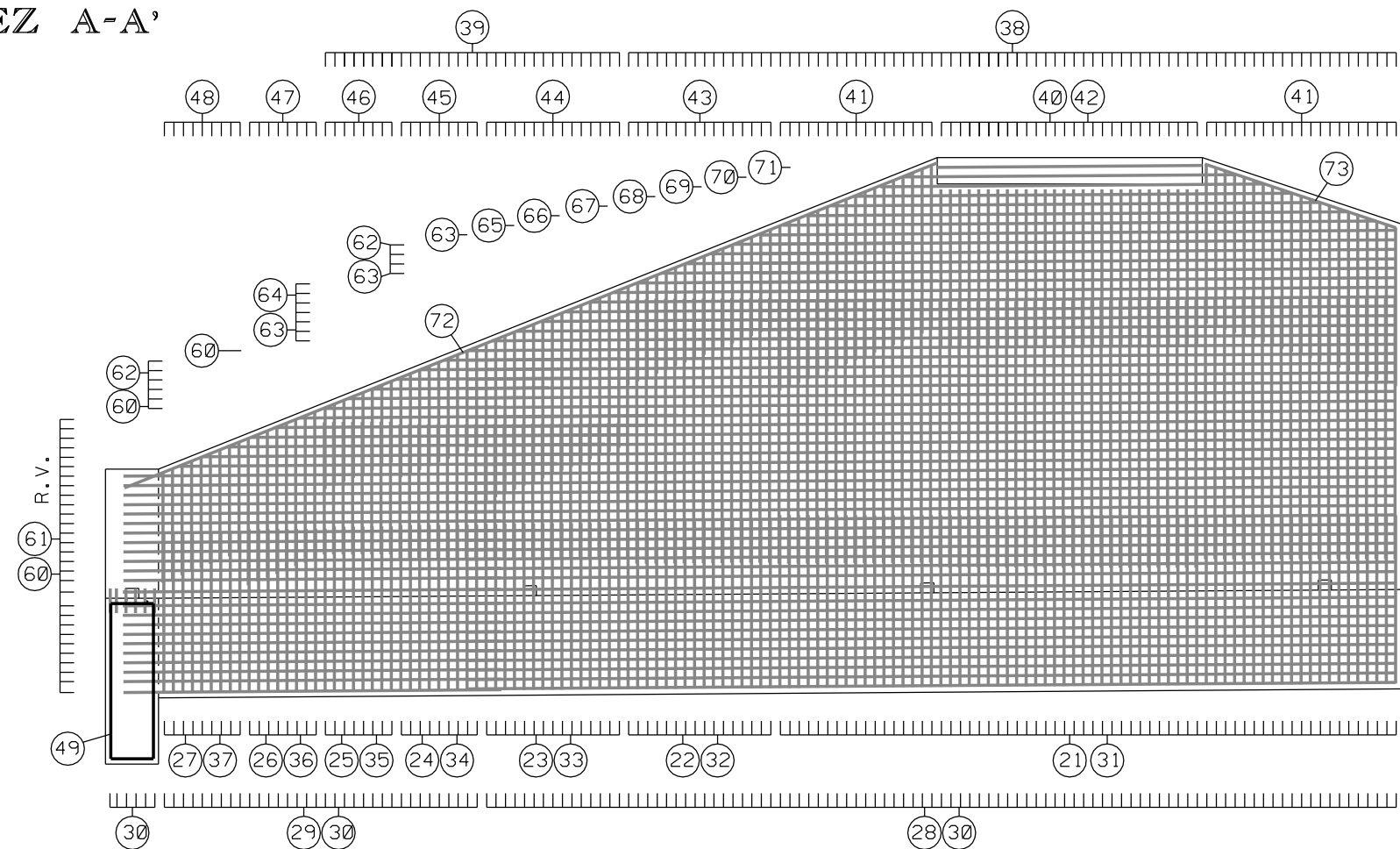

ŘEZ B-B'

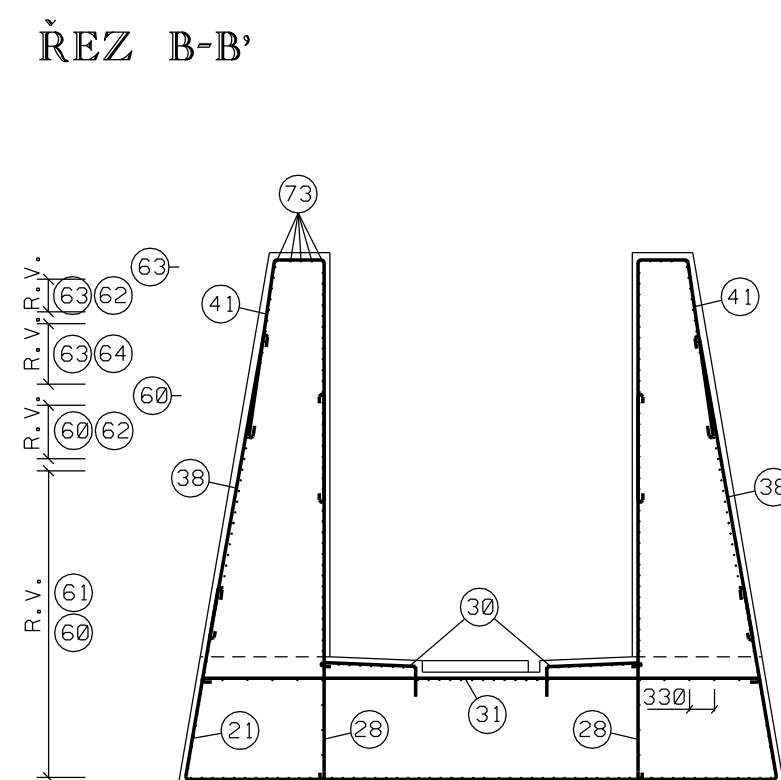

ŘEZ C-C'

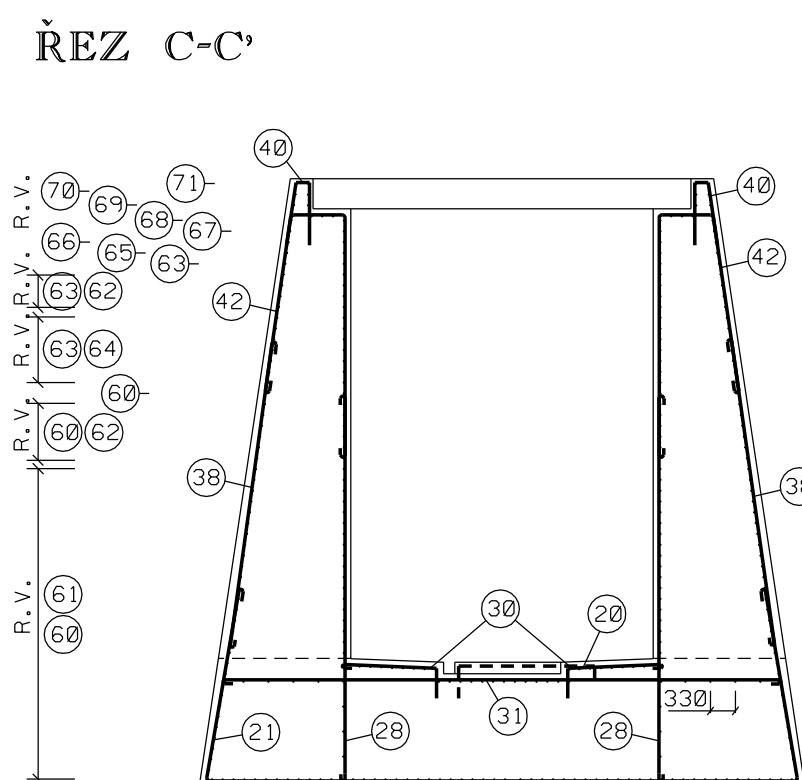

ŘEZ D-D'

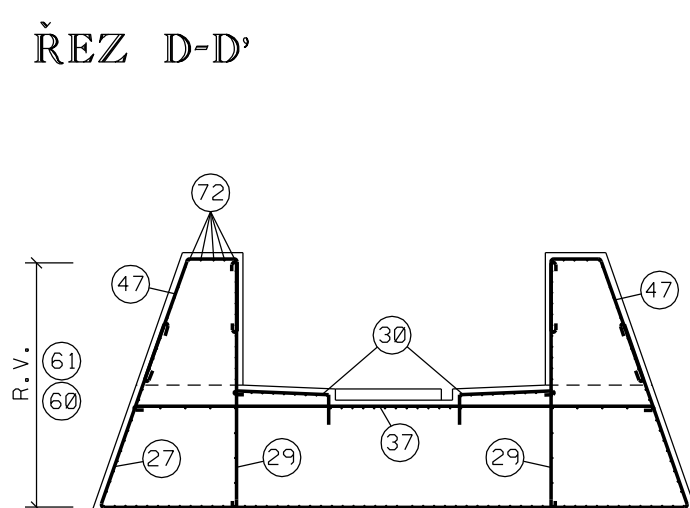

ŘEZ E-E'

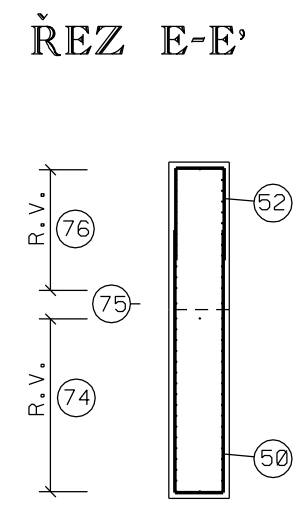

ŘEZ F-F'

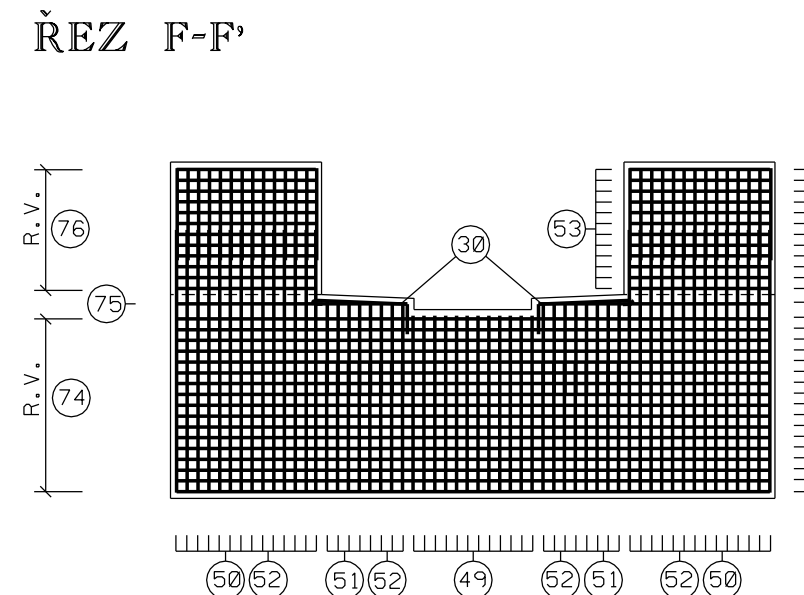

PŮDORYS

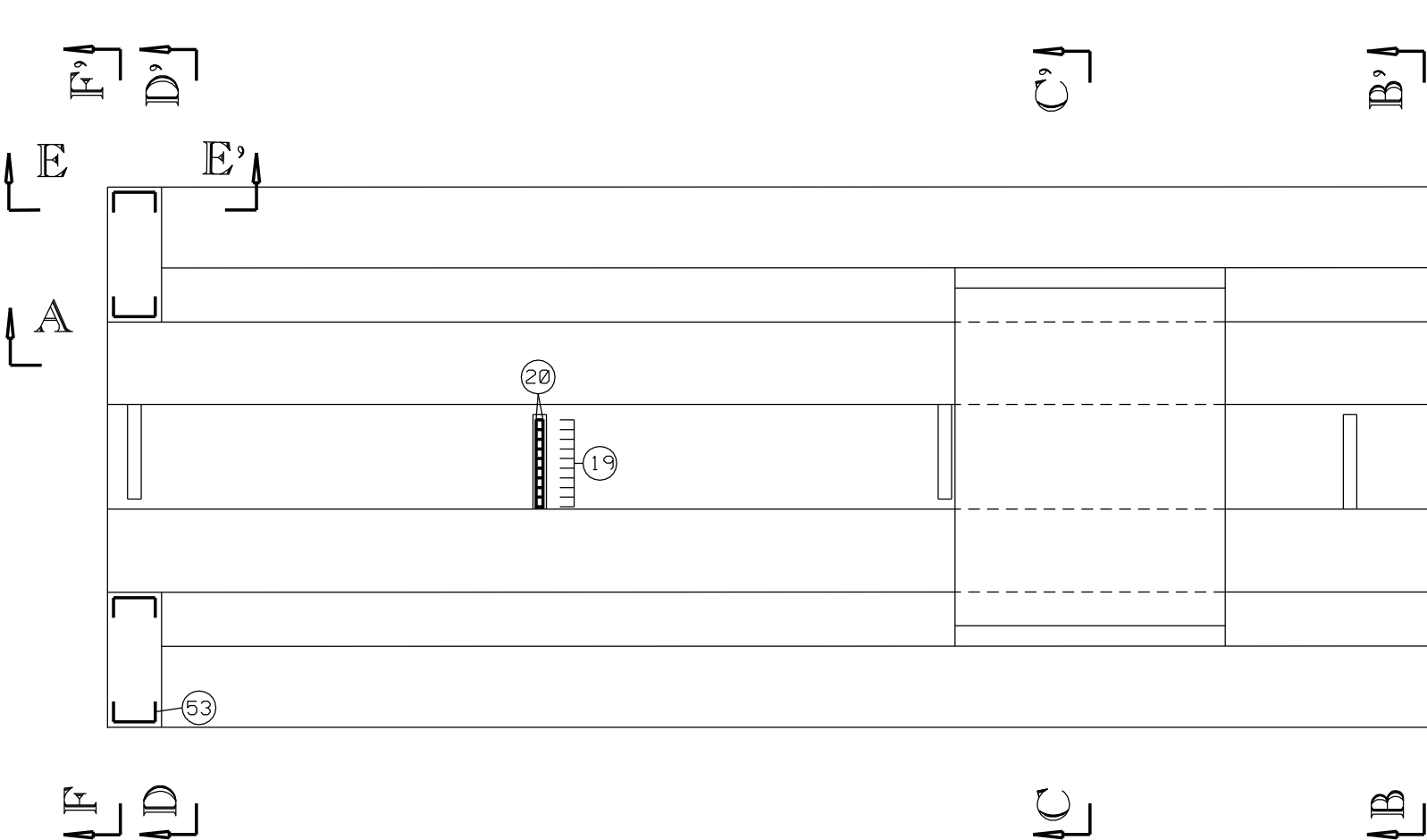

PEVNOSTNÍ SVAR:

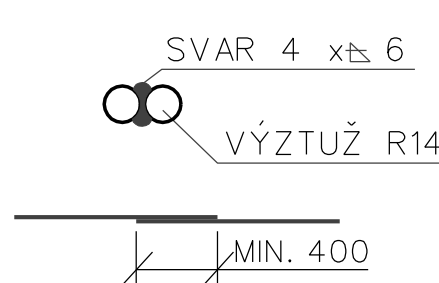

DETAIL STUPEŇ  
M 1:25

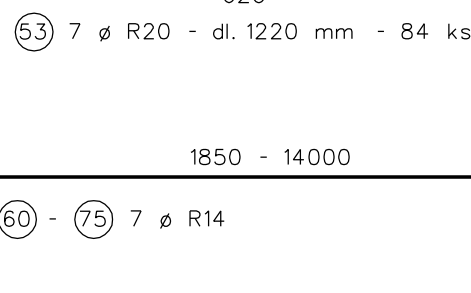
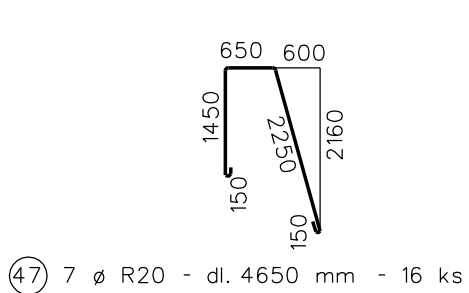
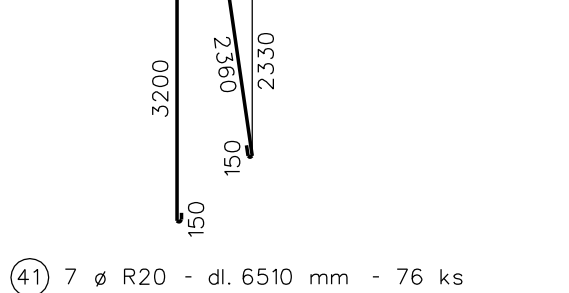
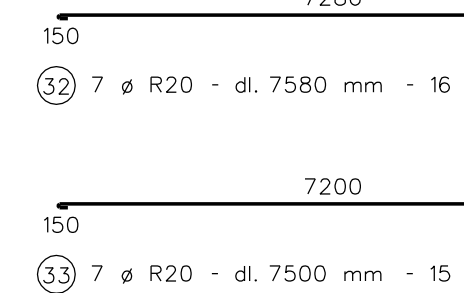
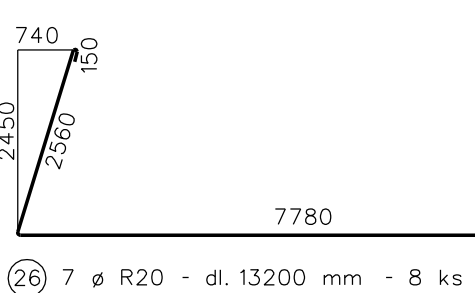
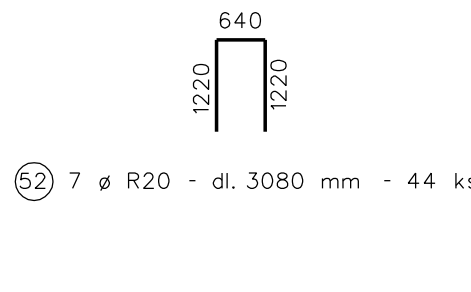
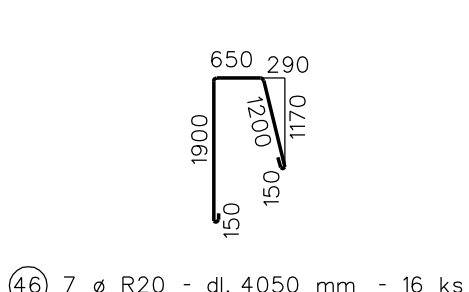
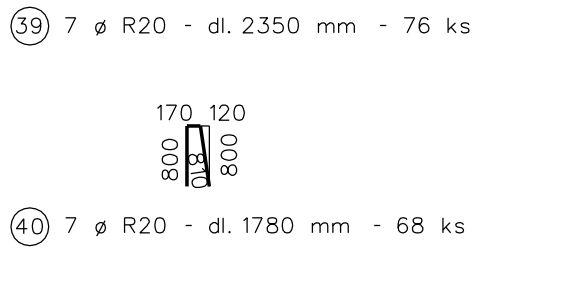
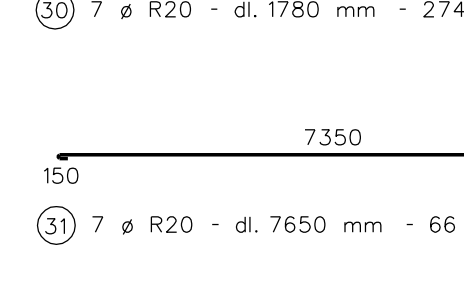
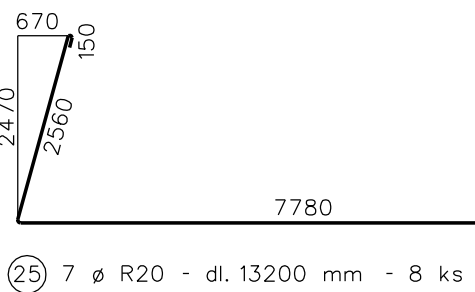
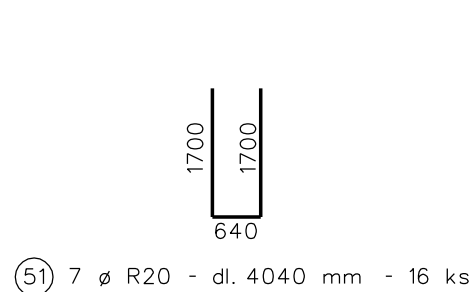
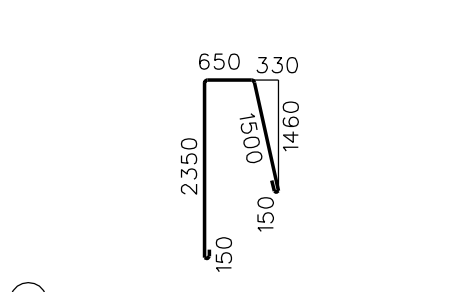
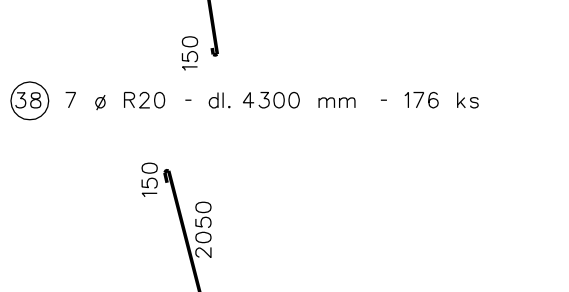
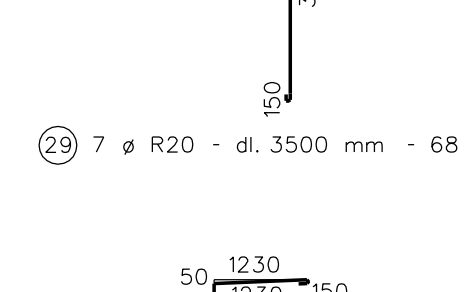
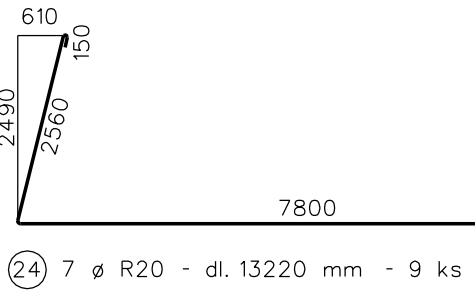
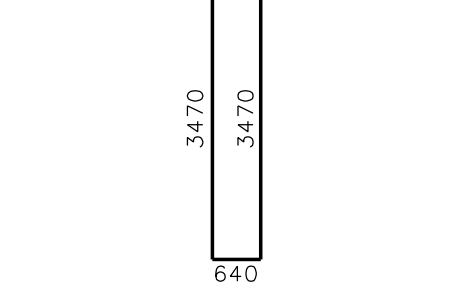
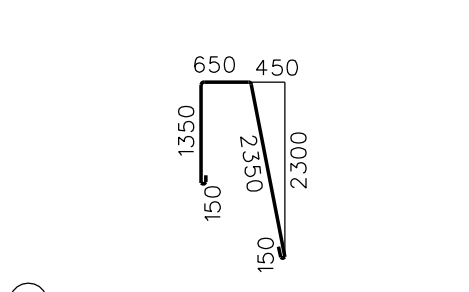
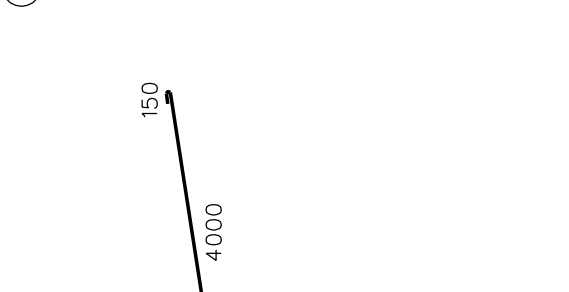
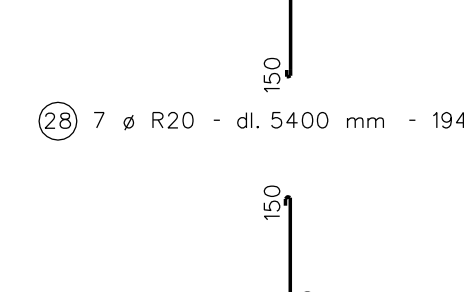
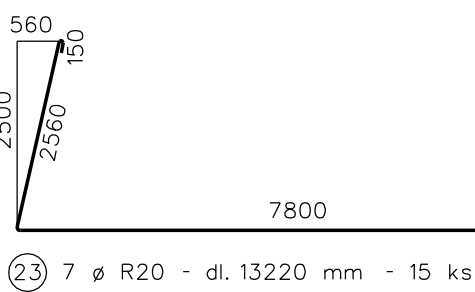
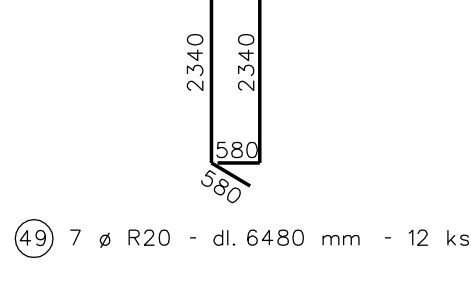
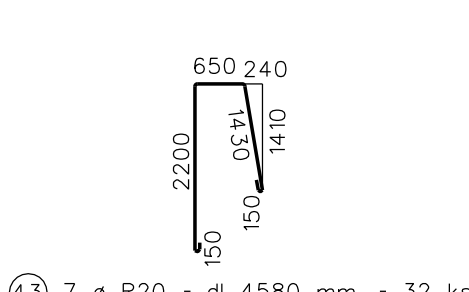
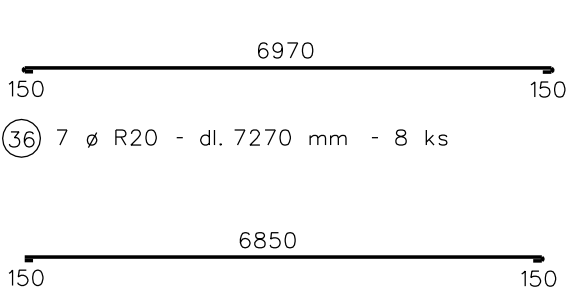
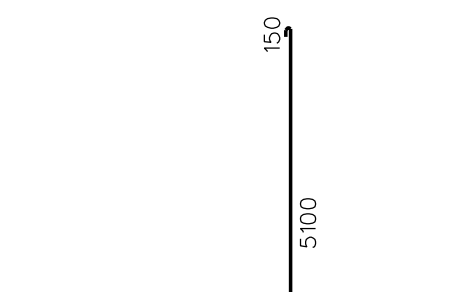
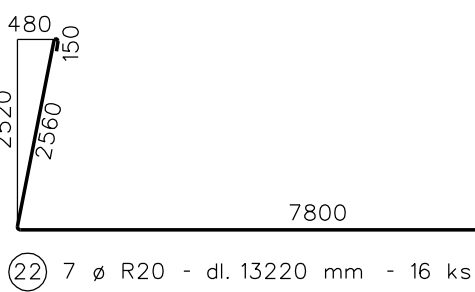
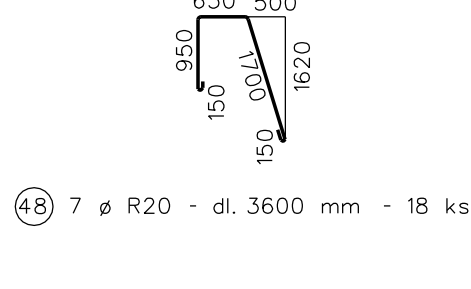
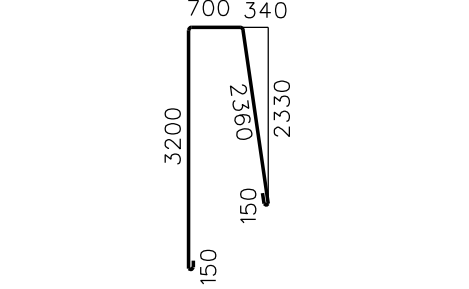
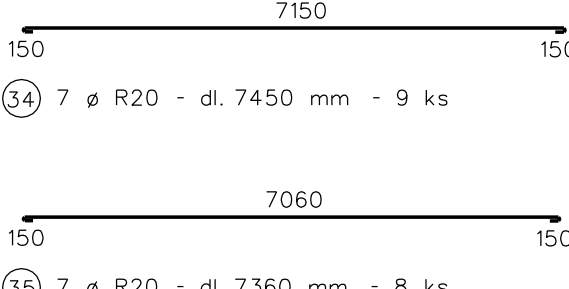
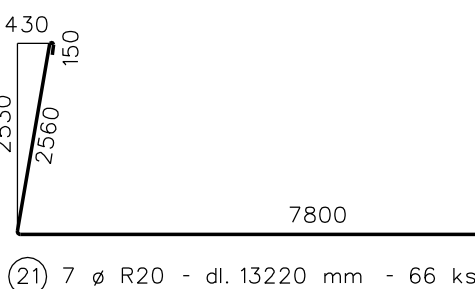
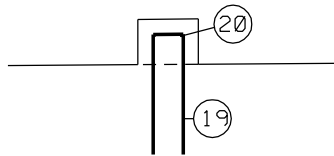

č	ø	ks	Material	
			ocel B500B	
			R20	
			délka (m)	celkem (m)
21	R20	66	13,22	872,5
22	R20	16	13,22	211,5
23	R20	15	13,22	198,3
24	R20	9	13,22	119,0
25	R20	8	13,20	105,6
26	R20	8	13,20	105,6
27	R20	9	13,18	118,6
28	R20	194	5,40	1047,6
29	R20	68	3,50	238,0
30	R20	274	1,78	487,7
31	R20	66	7,65	504,9
32	R20	16	7,58	121,3
33	R20	15	7,50	112,5
34	R20	9	7,45	67,1
35	R20	8	7,36	58,9
36	R20	8	7,27	58,2
37	R20	9	7,15	64,4
38	R20	176	4,30	756,8
39	R20	76	2,35	178,6
40	R20	68	1,78	121,0
41	R20	76	6,51	494,8
42	R20	68	6,56	446,1
43	R20	32	4,58	146,6
44	R20	30	4,65	139,5
45	R20	18	4,80	86,4
46	R20	16	4,05	64,8
47	R20	16	4,65	74,4
48	R20	18	3,60	64,8
49	R20	12	6,48	77,8
50	R20	28	7,58	212,2
51	R20	16	4,04	64,6
52	R20	44	3,08	135,5
53	R20	84	1,22	102,5
			bm	7658,0
			kg/bm	2,47
Celkem (kg)			18915,2	

č	ø	ks	Material	
			ocel B500B	
			R14	R14
			délka (m)	celkem (m)
19	R14	40	0,90	36,0
20	R14	8	2,40	19,2
60	R14	223	14,00	3122,0
61	R14	195	5,70	1111,5
62	R14	40	2,70	108,0
63	R14	48	9,60	460,8
64	R14	28	4,50	126,0
65	R14	4	9,00	36,0
66	R14	4	8,20	32,8
67	R14	4	7,40	29,6
68	R14	10	6,60	66,0
69	R14	4	5,80	23,2
70	R14	4	5,00	20,0
71	R14	4	4,00	16,0
72	R14	5	13,20	66,0
73	R14	5	3,00	15,0
74	R14	36	7,85	282,6
75	R14	4	3,05	12,2
76	R14	50	1,85	92,5
			bm	5675,4
			kg/bm	1,21
Celkem (kg)			6867,2	

BETON C30/37 XC4, XF3, XA2  
VÝZTUŽ: OCEL B500B, KRYTÍ 7 cm

Vypracoval	Zodpovědný Projektant	Zodpovědný Zástupce	Kontrola	 ROKÝCANOVA 114/IV VYSOKÉ MYTO 566 01
Kraj : Středočeský		PŮsRP : Čáslav		
OÚ : Močovice				
Investor : Státní pozemkový úřad, pobočka Kutná Hora				
Akce :				Stupeň : DSP
Poldr Cihelna v k.ú. Močovice				Datum : 10. 2018
				Formát : 10 A4
				Zak. číslo : 021 31/18
				Měřítko : 1:100
Obsah : Výztuž sdružený objekt výtok				Příloha : D.1.2.10.